

**SYSTEM**

PWS 85 IW TT A type

**NOTE.**

사용 가능 유리

복층유리 : 28mm

삼중유리 : 47mm

진공유리 : 28.3mm

열관류율

복층유리 : 1.3 Wm<sup>2</sup>/k

삼중유리 : 0.8 Wm<sup>2</sup>/k

진공유리 : 0.7 Wm<sup>2</sup>/k

REV.	DESCRIPTION	DATE
△		
△		
△		
△		
△		
△		

CODE NO.

PROJECT TITLE

DRAWING NAME

DRAWING BY

CHECKED BY

DATE

APPROVED BY

DRAWING NO

FILE NAME

(주)이건창호  
인천광역시 미추홀구 염전로 91 (도화동)  
T 1522-1271 F (032) 760 0697

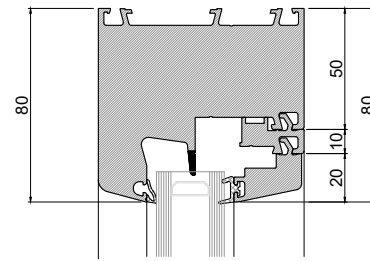
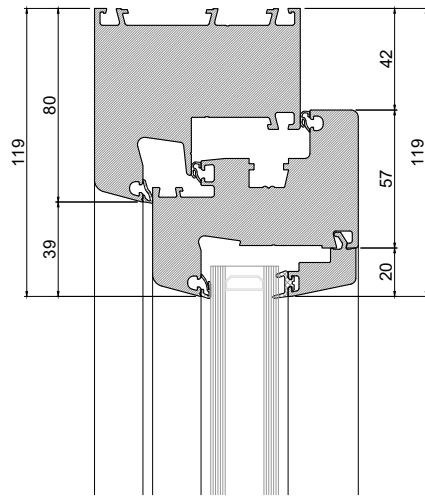

OUT 85 IN

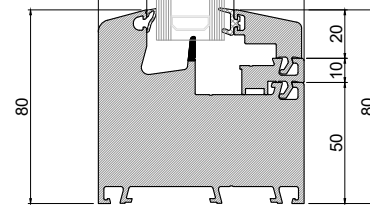

VERTICAL SECTION (B-B')

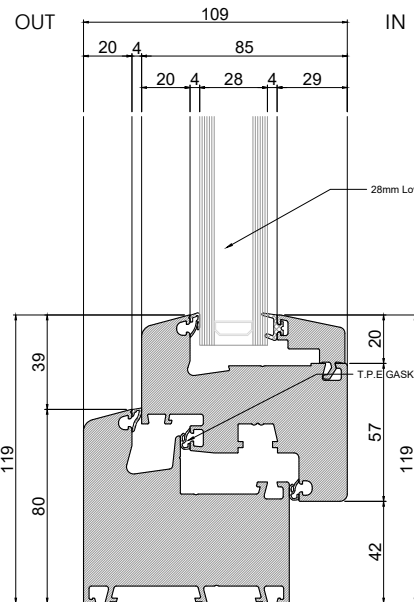

VERTICAL SECTION (A-A')

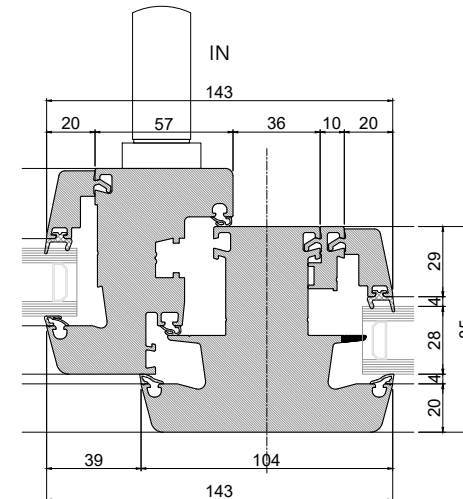
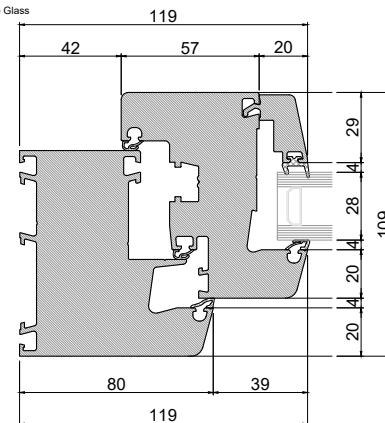

OUT

HORIZONTAL SECTION (C-C')

